

JUDY'S LEISURE TOURS, INC

Group travel at its best.

**FREE
AIRFARE**

FOR A LIMITED TIME!

Jewels of the Rhine

Switzerland • France • Germany • the Netherlands

Departure Date: September 11, 2025



Jewels of the Rhine



Lucerne, Switzerland – set amongst a backdrop of the Alps



Strasbourg, France proudly boasts diverse architecture

DAY 1 Depart the USA: Depart the USA on your overnight flight to Zurich, Switzerland.

DAY 2 Zurich to Lucerne, Switzerland: Upon arrival in Zurich, transfer to your hotel in Lucerne to begin your Swiss adventure. Flights should arrive by 3:00pm. The afternoon is at leisure to begin discovering your beautiful new surroundings. This evening, join your Mayflower representative and traveling companions for an included dinner at the hotel. **Meal: D**

DAY 3 Lucerne: After breakfast, an included walking tour highlights the city's landmark, the famous 14th-century Chapel Bridge with its paintings of heroic town events, that crosses the Reuss River. See the 17th-century Renaissance Town Hall and town squares, all set amongst the beautiful backdrop of the Swiss Alps. The remainder of the day is at leisure. **Meal: B**

DAY 4 Lucerne – Basel: Before departing for your ship in Basel, the day is free to enjoy at leisure or join the morning optional excursion to Mt. Pilatus – a mountain overlooking Lucerne that offers a unique alpine experience! This afternoon, travel by motorcoach to Basel, Switzerland for embarkation of your luxurious Emerald Cruises Star-Ship. This evening, join your fellow travelers for dinner onboard. **Meals: B, D**
DiscoverMORE: Mt. Pilatus (additional expense)

DAY 5 Breisach, Germany: As part of the EmeraldPLUS program, visit the city of Freiburg. Considered the 'capital of the Black Forest', Freiburg has lovely sights that will leave you amazed. You also have the opportunity to sample true Black Forest delicacies from the lively market in the city center near the main cathedral. If you're feeling more active, join the guided bike tour in Breisach. Enjoy local entertainment onboard this evening. **Meals: B, L, D**

EmeraldPLUS: Guided tour of Freiburg

EmeraldACTIVE: Bike tour in Breisach

DAY 6 Strasbourg, France: Once docked in Kehl, coaches await to take you across the river to Strasbourg, the capital city of the Alsace Region in France. The guided walking tour takes you along narrow lanes and across footbridges as you discover the Grande Île, the historical city center and UNESCO World Heritage Site. Known for its medieval black and white timber-framed buildings, picturesque le Petite France, old tanning houses, canals and river locks, the city's star attraction is the ornate cathedral, dominating the main square. This afternoon, the city is yours to explore at leisure. **Meals: B, L, D**

DAY 7 Ludwigshafen / Heidelberg, Germany: Relax onboard as the vessel cruises along the Rhine River to Ludwigshafen, docking site for Heidelberg. Travel by coach to Heidelberg, home of the oldest university in Germany. The guided walking tour visits the ruins of Heidelberg Castle, with fantastic views overlooking the Neckar River, and takes you through the cobblestoned-streets of the medieval city below. Alternatively, hike from Mount Königstuhl to Heidelberg. Local entertainment is provided onboard this evening. **Meals: B, L, D**

EmeraldACTIVE: Hike from Mount Königstuhl to Heidelberg

DAY 8 Koblenz: Begin the day sailing through the spectacular UNESCO World Heritage Rhine Gorge. Pass countless medieval castles and vineyards lining the shores of this section of the river, with photo opportunities around every bend. See the infamous Lorelei statue and Pfalzgrafenstein Castle, built on an island in the middle of the river as a medieval toll station. Continue cruising to the 2000-year-old town of Koblenz, situated at the confluence of the Rhine and Moselle Rivers. Enjoy a walking tour through the streets of the city as your guide points out historic monuments and buildings. See the 'German Corner' monument marking the confluence of the Rhine and Moselle Rivers. Panoramic views await from the visit to Ehrenbreitstein Fortress, reached by cable car, crossing the river!



Relax during a glass-top canal cruise through Amsterdam

This evening, attend a private concert as part of the EmeraldPLUS program. **Meals: B, L, D**

DiscoverMORE: Moselle & Cochem (Reichsburg) Castle Visit (additional expense)

EmeraldPLUS: Private Evening Concert

DAY 9 Cologne: Continue cruising along the Rhine River to Cologne. Founded by the Romans, the city is one of Germany's oldest and is famous for its magnificent UNESCO World Heritage gothic cathedral. Join your local guide for an included walking tour of the city, touching on the historical charm of the Old Town and its Roman history. Traverse the quaint alleyways and see historic monuments alongside modern architecture. The remainder of the day is at leisure. This evening, back onboard, join your Captain for a farewell reception and dinner. **Meals: B, L, D**

DAY 10 Amsterdam, the Netherlands: Welcome to Amsterdam, the final port of call. Experience the city on a cruise aboard a glass-top boat. Traverse the UNESCO World Heritage network of canals, passing Roman patrician and ornate merchant houses from the Dutch Golden Age. Alternatively, join a guided bike tour to Waterland, passing through quintessential Dutch landscapes of quaint villages and windmills. **Meals: B, L, D**
EmeraldACTIVE: Guided bike tour to Waterland (instead of canal cruise)

DAY 11 Amsterdam / USA: Bid 'auf wiedersehen' to Europe and return home with memories of life-enriching experiences from your European adventure and cruise along the Rhine River. **Meal: B**
 Itinerary is subject to change.

CRUISE AND HOTEL ACCOMMODATIONS

Days 2 and 3 – Hotel Europe or similar, Lucerne, Switzerland

Days 4 through 10 – Aboard an Emerald Cruises Star-Ship
 Post-cruise hotel stays available in Amsterdam. Call for details.



Exceptional Inclusions

- **23 Meals:** 9 breakfasts, 6 lunches and 8 dinners
- **Airport transfers** on tour dates when air is provided by Mayflower Cruises & Tours
- Visit **four countries**
- Two-night **hotel stay and touring in Lucerne**
- **Seven-nights in a suite or stateroom** of your choice onboard the vessel
- **First-class service** by an English-speaking crew
- **Onboard Activity Manager** will support all EmeraldACTIVE excursions and host daily onboard wellness activities, games, classes and evening entertainment
- **All gratuities included**
- **Shore excursions** with English-speaking local guides
- Personal **listening device** for shore excursions
- Visit **UNESCO World Heritage Sites**
- **All meals included** onboard with a variety of **international cuisine**
- Complimentary **regional wines, beer and soft drinks** with onboard lunches and dinners
- Complimentary **bottled water** in your stateroom
- Complimentary **WiFi onboard**
- Complimentary **bicycles onboard** for use ashore
- **All port charges included**

Emerald Cruises Star-Ships

Built: 2014-20 **Speed:** 15.5 mph **Staterooms:** 19 **Suites:** 72 **Length:** 443 ft. **Crew:** 47

SUN DECK

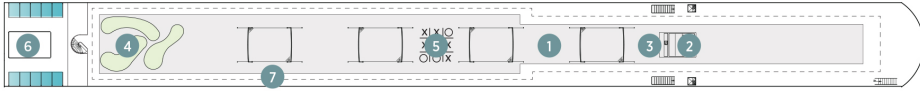

HORIZON DECK

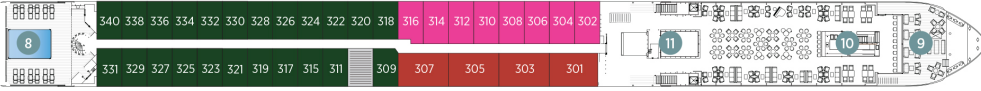

VISTA DECK

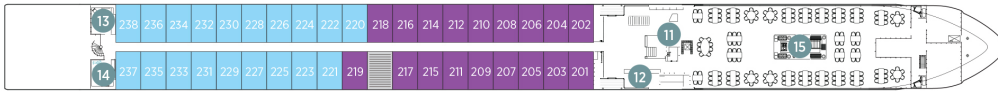

RIVIERA DECK

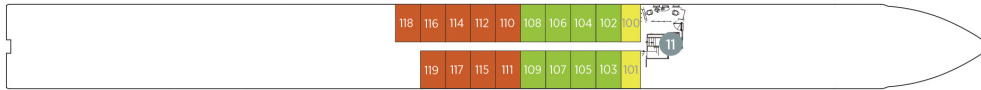

Public Areas and Ship Amenities

- 1 Sun Deck with Deck Chairs
- 2 Navigation Bridge
- 3 Sky Barbeque
- 4 Golf Putting Green
- 5 Games Area
- 6 Retractable Glass Roof
- 7 Walking Track
- 8 Daytime Pool / Evening Cinema
- 9 The Terrace
- 10 Horizon Bar and Lounge
- 11 Elevator
- 12 Reception
- 13 Wellness Area
- 14 Fitness Area
- 15 Reflections Restaurant

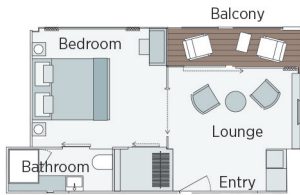

Owner's One-Bedroom Suite

315ft²

CAT SA

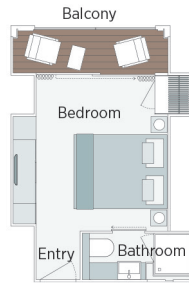

Grand Balcony Suite

210ft²

CAT S



Panorama Balcony Suite

180ft²

CAT A CAT B CAT C

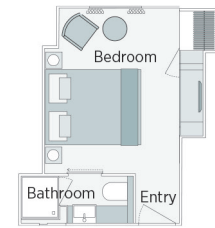

Emerald Stateroom

162ft²

CAT D CAT E

Jewels of the Rhine

		SEPTEMBER 11, 2025	
CAT	STATEROOM / SUITE	DECK	
E	Emerald Stateroom	Riviera	\$5,275
D	Emerald Stateroom	Riviera	\$5,385
C	Panorama Balcony Suite	Vista	\$6,009
B	Panorama Balcony Suite	Vista	\$6,289
A	Panorama Balcony Suite	Horizon	\$6,579
S	Grand Balcony Suite	Horizon	\$7,029
SA	Owner's One-Bedroom Suite	Horizon	\$7,939

Pricing includes round trip Fargo or Bismarck airfare, hotel transfers, land/cruise package, 25 meals, wine and beer with lunch and dinners, gratuities to the guides, drivers and ship staff and professional tour manager.

Air itineraries may not be available until documents are received. Air seats are assigned by the airline for the entire group and may not be available until airport check-in. Seat changes can only be attempted at the airport and may not be possible. If specific seat assignments are vital to your reservation, we recommend booking air on your own rather than booking air with the group.

Travelers Protection Plan (TPP) for River Cruises - \$569 per person

This nonrefundable fee will provide a refund to you during the instance that you have to cancel your trip. The cancellation has to be for a covered reason (see Plan for details on coverage) and we have to be notified at least one day prior to departure. If you must leave the tour early due to personal illness or the illness or death of an immediate family member, TPP will provide a refund for any unused services after the departure of the tour. Other benefits include medical expenses for illness and injury, emergency transportation, 24 hour hot line and lost or stolen baggage assistance. Return air transportation is included ONLY if your air tickets are purchased through Mayflower Cruises & Tours. Please review the Plan for details on coverage. Should you choose not to purchase our TPP, the following per person cancellation charges will be assessed for all tours and optional excursion costs:

- 91 days or more prior to departure: Deposit Amount
- 90 days to day of departure: 100% of total tour
- No refund on unused portions of the tour



Exclusions: Mayflower Cruises & Tours reserves the right to alter its Refund and Cancellation Policy when a substantial amount of cancellation or postponement of travel is attributable to: conditions resulting from an act of God, natural or man-made disaster, fire, government action, civil disorder, war, hostilities between nations, or unavailability of transportation through no fault of Mayflower Cruises & Tours. *Plan and benefits offered and administered by Trip Mate, Inc.*

FOR RESERVATIONS OR INFORMATION CONTACT:

Judy or Sue

at **(701) 232-3441**

or **judyt@cableone.net**



Today's Date: _____

Tour: Jewels of the Rhine

Departure Date: 09/11/2025

Group Name: Judy's Leisure Tours

Group Number: 306034



For Reservations Contact: Judy's Leisure Tours
Judy or Sue
(701) 232-3441
judyltours@gmail.com

Deposit Amount: \$ 400pp
Travel Protection Plan: Yes No
Cruise price up to \$5000 \$ 499pp
Cruise price \$5001 and up \$ 569pp
Total Amount Enclosed: \$ _____
Final Payment Due By: 06/06/2025

IMPORTANT: Please print your name EXACTLY as it appears on your passport. We require a copy of your passport within two (2) weeks of making your reservation. Name corrections, after final payment due date or after tickets have been issued, will result in additional fees being assessed.

YOUR INFORMATION

Salutation: _____ First: _____ Middle: _____ Last: _____ Suffix: _____ Nickname: _____
(Mr., Mrs., Rev) (Please print EXACTLY as it appears on Passport) (Jr., Sr)

Address: _____ City: _____ State: _____ Zip Code: _____

Phone: _____ Cell: _____ Email Address: _____

Passport Number: _____ Date of Issue: _____ Date of Expiration: _____

Issue City, State, Country: _____ Global Entry/TSA #: _____ Citizenship: _____

Date of Birth: _____ Place of Birth: _____ Gender: Male Female

Emergency Contact: _____ Relationship: _____ Phone: _____
Please provide contact information of person not traveling with you.

ROOMING WITH

Salutation: _____ First: _____ Middle: _____ Last: _____ Suffix: _____ Nickname: _____
(Mr., Mrs., Rev) (Please print EXACTLY as it appears on Passport) (Jr., Sr)

Address: _____ City: _____ State: _____ Zip Code: _____

Phone: _____ Cell: _____ Email Address: _____

Passport Number: _____ Date of Issue: _____ Date of Expiration: _____

Issue City, State, Country: _____ Global Entry/TSA #: _____ Citizenship: _____

Date of Birth: _____ Place of Birth: _____ Gender: Male Female

Emergency Contact: _____ Relationship: _____ Phone: _____
Please provide contact information of person not traveling with you.

Please advise your departure airport for this tour: _____ Mayflower Air Writing Own Air

PAYMENT INFORMATION

Make Checks Payable To: Judy's Leisure Tours

Mail Deposit To: Judy's Leisure Tours
4906 County Road 31
Fargo, ND 58102

Mail Final Payment To: SAME AS ABOVE

****MC, VISA & DISC accepted****

Credit Card #: _____

Security Code: _____ Exp. Date: _____

Cardholder Name & Billing Address:

Single Twin Guaranteed Share

Stateroom Category

Riviera Deck (CAT E) Riviera Deck (CAT D)
 Vista Deck (CAT C) Vista Deck (CAT B)
 Horizon Deck Grand Balcony Suite
 Owners Suite

We will make every effort to accommodate your preference of cabin category. All cabins are on a first-come, first-serve basis.

Requested cabin # _____ 2nd Preference # _____

One Bed Two Beds

*Mayflower's Guaranteed Share Program is available on the Riviera, Vista and Horizon Decks standard staterooms only.

2025 RIVER CRUISING & SMALL SHIP ADVENTURES

Booking Conditions

Payments: All deposits and final payments can be made by check or credit card. We accept the following credit cards: Visa, MasterCard and Discover.

Prices Subject to Change: We reserve the right to vary itineraries and prices and substitute facilities, hotels or events of equal or better quality if necessary.

Guaranteed Share Program for Single Travelers: If you are traveling alone and would like a roommate for cost savings, let us know at the time of booking your reservation. Travelers must be non-smokers and cannot use a medical sleeping device to be eligible. Participants will be paired with another traveler of the same gender at the twin rate. If no roommate is available, you will get a single room at the twin rate. Guaranteed share reservations are available 180 days prior to departure.

Roommate Cancellation: If you are booked as a "twin" and your roommate cancels their reservation, and you cannot find another roommate, you may either travel as a guaranteed share (see above) or travel as a single and pay the single supplement.

Health and Walking on Tour: Some sites visited have limited motorcoach access and may involve considerable walking, stairs or inclines. Travelers should be in reasonably good health. Some programs include destinations in higher elevations that may have varying effects on individual travelers. Tour Managers and Coach Drivers cannot lift or assist travelers into transportation vehicles. Mayflower Cruises & Tours requires that persons requiring assistance be accompanied by a companion who is capable of and totally responsible for providing the assistance.

Revision Fees: A fee of \$25 per person per transaction will be charged for any changes, revisions or alterations made to your reservation after confirmation.

Luggage Handling: The tour cost includes portage for one average size suitcase. A charge of \$5.00 per hotel will be collected by the Tour Manager for each additional piece of luggage that you bring.

Travel Documents: Your travel documents will be in your possession approximately 14 days prior to departure. Documents include tour itinerary, departure and arrival information and times, hotel and ship information, clothing suggestions, baggage tags, plus any helpful hints.

Mayflower Loyalty Program: Earn \$150.00 travel credit for every River Cruise and Small Ship Adventure taken with Mayflower Cruises & Tours. No restrictions to the amount of credits an individual can acquire. Loyalty Credits can be applied to any reservation made within one year of the return of the tour they were earned on. Multiple credits can be used on a single tour. Credits are nontransferable but can be combined with Mayflower promotional savings. Some restrictions apply, call for details.

Smoke Free Environment: Although smoking is not allowed on the motorcoach, frequent rest/smoking stops are made.

Travelers with Special Needs: You must advise Mayflower at the time your booking is made of any disability requiring special attention. Mayflower will make reasonable efforts to accommodate the special needs of our travelers. Be aware that the Americans with Disabilities Act is applicable only within the United States and that accommodations for disabled travelers outside the United States may be more limited. If a traveler requires assistance, we require that he/she be accompanied by a companion who is capable of and totally responsible for providing the assistance. Neither Mayflower personnel, nor its suppliers, may lift or physically assist travelers. If a traveler thinks he/she might need assistance during a trip, he/she should call Mayflower to determine what assistance might reasonably be provided. If special arrangements are provided, and

these arrangements add to the Tour Operator's cost, the Tour Member will be responsible to pay the additional costs. Mayflower cannot provide special individual assistance to travelers with special needs for walking, dining or other routine activities.

Membership: Mayflower reserves the right to withhold tour membership, or to require any traveler to leave a tour at any time, when such action is determined by Mayflower to be in the best interests of the traveler or the tour group. Children must be at least 12 years of age and accompanied at all times by a guardian.

Force Majeure: Except where otherwise expressly stated in these terms and conditions we cannot accept liability or pay any compensation where the performance or prompt performance of our obligations under our contract with you is prevented or affected by or you otherwise suffer any damage, loss or expense of any nature as a result of Force Majeure. "Force Majeure" means any event which we or the supplier of the services in question could not, even with all due care, foresee or avoid.

Responsibility: These tour programs are operated by Mayflower Cruises & Tours, Inc. 650 Warrenville Rd, Suite 500, Lisle, IL 60532. In common with other companies, Mayflower acts only as an agent for Tour Members in arranging room accommodations, transportation, sightseeing, admissions and restaurants. Mayflower reserves the right in its sole discretion to make changes in the itinerary and is not responsible for expenses, loss of time, money or other occurrence resulting from a change of tour scheduling made for Tour Members. Mayflower reserves the right to accept, decline or retain any person as a member of the tour, and is not responsible for any losses or damages of personal property, or for injuries, expenses or damages incurred by any Tour Member.

United States Tour Operators Association \$1 Million Travelers Assistance Program: Mayflower Cruises & Tours, Inc. shares the coverage available under the United States Tour Operators Association ("USTOA") \$1 Million Travelers Assistance Program with affiliates of Mayflower Cruises & Tours who, as an Active Member of the USTOA is required to post \$1 Million with USTOA to be used to reimburse, in accordance with the terms and conditions of the USTOA Travelers Assistance Program, the advance payments of Mayflower Cruises & Tours travelers in the unlikely event of Mayflower Cruises & Tours bankruptcy, insolvency or cessation of business. Further, you should understand that the \$1 Million posted by Mayflower Cruises & Tours may be sufficient to provide only a partial recovery of the advance payments received by Mayflower Cruises & Tours. Complete details of the USTOA Travelers Assistance Program and a list of affiliates may be obtained by writing to USTOA at 345 Seventh Avenue, Suite 1801, New York, NY 10001, or by email to information@ustoa.com or by visiting www.ustoa.com.

Airline Security Measures: The Transportation Security Administration requires that travelers provide their name exactly to their airline as it appears on their passport to be used while traveling, along with their date of birth and gender when making reservations to fly from the U.S. When making your flight reservations through Mayflower Cruises & Tours, you will be asked for this information by our staff. Due to airline security measures, your passport must match your airline ticket name and your tour reservation name or you may be denied aircraft boarding.

Passport & Visas: Each U.S. citizen must have a valid passport. Expiration date of passport should be at least six months after the return date of the tour. If you don't have a passport, call our office and we'll tell you how to apply for one. Some countries require visas for entry by U.S. citizens. We will send instructions for visa applications if a visa is required for your tour. Holders of non-U.S. passports should contact their nearest consulate and inquire about the necessary passport or visa documentation required for entry into the countries visited. Visa fees and cost of obtaining a visa are not included in the tour price and are the responsibility of the traveler.

Cruise: (a) Noise, Vibration and Odor: While We take reasonable steps to minimize noise, vibrations and odors on the cruise ships, You acknowledge and accept that some noise, vibration and intermittent odors may be experienced on vessels and that We will not be liable to You in relation to any such noise, vibration or odors.

(b) Docking Position: During port stops, ships may dock side-by-side, obstructing views and requiring You to pass through other ships to embark and disembark.

DEPOSIT SCHEDULE - SCENIC, EMERALD AND GALÁPAGOS LAND/ CRUISE TOUR PRICE UP TO \$5,000

Land/Cruise Tour with Air*	Deposit Per Person	Final Payment
• With TPP Coverage	\$899	90 Days
• Without TPP Coverage	\$400	90 Days
Land/Cruise Tour Only	Deposit Per Person	Final Payment
• With TPP Coverage	\$799	90 Days
• Without TPP Coverage	\$400	90 Days

DEPOSIT SCHEDULE - SCENIC, EMERALD AND GALÁPAGOS LAND/ CRUISE TOUR PRICE FROM \$5,001 AND UP

Land/Cruise Tour with Air*	Deposit Per Person	Final Payment
• With TPP Coverage	\$969	90 Days
• Without TPP Coverage	\$400	90 Days
Land/Cruise Tour Only	Deposit Per Person	Final Payment
• With TPP Coverage	\$869	90 Days
• Without TPP Coverage	\$400	90 Days

DEPOSIT SCHEDULE - TREASURES OF THE PHAROAH'S

Land/Cruise Tour with Air*	Deposit Per Person	Final Payment
• With TPP Coverage	\$899	90 Days
• Without TPP Coverage	\$400	90 Days
Land/Cruise Tour Only	Deposit Per Person	Final Payment
• With TPP Coverage	\$799	90 Days
• Without TPP Coverage	\$400	90 Days

DEPOSIT SCHEDULE - MAJESTIC MEKONG RIVER CRUISE; TREASURES & TEMPLES OF VIETNAM AND CAMBODIA; SPLENDORS OF EUROPE

Land/Cruise Tour with Air*	Deposit Per Person	Final Payment
• With TPP Coverage	\$1,099	90 Days
• Without TPP Coverage	\$400	90 Days
Land/Cruise Tour Only	Deposit Per Person	Final Payment
• With TPP Coverage	\$999	90 Days
• Without TPP Coverage	\$400	90 Days

*Land tour price is based on twin occupancy rate

Payment Information: Listed above is a schedule of deposit and final payment due dates. You will note that the first category includes an optional Travelers Protection Plan (TPP) which is to be paid within five business days after making your reservation. Please see "Travelers Protection Plan (TPP)" section in the next column for further explanation of this benefit.

Refund and Cancellation Policy: Payments for land, air and cruise arrangements (less the deposit amount) will be refunded when cancellations are received prior to the final payment due date noted above. Deposits are non-refundable unless the optional Travelers Protection Plan (TPP) is purchased at the time of booking. When the optional Traveler Protection Plan is purchased and it is necessary to cancel your reservation, you will be refunded all payments, including the deposit amount, less the TPP premium. All refunds will be processed by Trip Mate, a Generali Global Assistance & Insurance Services brand. Please go to www.tripmate.com/wpf431G for details on the coverage for the Traveler Protection Plan. Should you choose not to purchase our TPP, the following per person cancellation charges will be assessed for all tours and optional excursion costs:

- 91 days or more prior to departure: Deposit Amount
- 90 days to day of departure: 100% of total tour
- No refund on unused portions of the tour