

# Portugal and the Douro River Cruise

Travel Dates: April 29 - May 9, 2026

**JUDY'S LEISURE  
TOURS, INC**

*Group travel at its best.*

# Portugal and the Douro River Cruise



Experience the cosmopolitan charm of Lisbon, Portugal



Feel the rhythm of the city in the Plaza Mayor, Salamanca, Spain

**DAY 1 Depart the USA:** Depart the USA on your overnight flight to Lisbon, Portugal.

**DAY 2 Lisbon, Portugal:** Upon arrival, you'll be met by a representative of Mayflower Cruises & Tours and transferred to your hotel. The remainder of the day is at your leisure to explore Lisbon. This evening, join your Mayflower staff and fellow travelers for an included dinner. **Meal: D**

**DAY 3 Lisbon:** After breakfast, an included tour highlights the famous sites of the city. During a panoramic coach tour, see 'Monument to the Discoveries,' and Belem Tower, a UNESCO World Heritage Site. Visit Jerónimos Monastery and discover the unique architecture and history. Enjoy a free afternoon to shop, dine and experience this cosmopolitan city on your own. **Meal: B**

**DAY 4 Fátima – Coimbra – Porto:** Depart Lisbon by coach and journey to the ship in Porto. Enroute, visit Fátima, home to the Sanctuary of Fátima, an important Catholic pilgrimage site. The city's fame originates from the apparitions of Our Lady of the Rosary that appeared to three shepherd children in the nearby fields. Continue to Coimbra and its famous university before arriving in Porto to embark the *MS Emerald Radiance*, home for the next seven nights. **Meals: B, D**

**DAY 5 Porto – Pinhão:** Today is a day of sailing through the twists and turns of the Douro Valley. Designated a UNESCO World Heritage Site, this area is sparsely populated by quaint villages, sun-drenched vineyards and small farms. Later today, arrive in the village of Pinhão, perfectly situated on a river bend surrounded by terraced hillsides that produce some of the world's best Port wine. Tonight, enjoy a welcome reception and dinner. **Meals: B, L, D**

**EmeraldPLUS:** A Portuguese cooking demonstration onboard

**DAY 6 Pinhão – Vega de Terrón:** Begin the day with a visit to the beautiful 18th-century estate of Quinta do Tedo Vineyard with spectacular views of the Douro Valley. Learn about wine production, its importance to the culture and economy, and enjoy a tasting of the local vintage. Alternatively, enjoy a guided walk through local vineyards OR, embark on a kayak excursion along the river. This afternoon, the ship sails for Vega de Terrón, gateway to Spain. **Meals: B, L, D**

**EmeraldACTIVE\*:** A guided walk through the vineyards

**EmeraldACTIVE\*:** Kayak experience in Pinhão

\*The included tour and both ACTIVE tours all operate simultaneously. Only one can be selected.

**DAY 7 Salamanca, Spain:** Today's excursion takes you to the UNESCO World Heritage Site of Salamanca, Spain. During the guided walking tour, see amazingly detailed and intricately carved buildings of the university and the House of Shells. Regal splendor abounds in the Plaza Mayor, the heartbeat of the city. You'll have free time for lunch and to explore independently before returning to the ship in Portugal. **Meals: B, D**

**EmeraldPLUS:** Entertainment by a Tuna music band in Salamanca

**DAY 8 Pocinho / Régua, Portugal:** An early afternoon arrival brings you to Pocinho. Disembark for an included visit to the medieval town of Castelo Rodrigo. Uncover the secrets of its fortress and perhaps try some typical local products. Return to the ship for lunch and relax on deck as the ship sails through idyllic surroundings on the way to Régua. **Meals: B, L, D**

**DiscoverMORE:** Archaeological 4x4 Tour at Côa Museum (additional expense)

The included tour and DiscoverMORE operate at the same time.

**EmeraldPLUS:** Port wine cocktail lesson onboard

**DAY 9 Régua – Lamego:** From Régua, journey by coach to the marvelous baroque village of Lamego, home to the Sanctuary of Our Lady of Remedies - one of the most important



The quaint and historic town of Porto, Portugal

pilgrimage sites in Portugal. Visit the Sanctuary perched atop the hill, with its iconic 686-step granite staircase, decorated with the traditional Portuguese blue and white 'azulejos' tiles. This afternoon, experience a rural lunch at Quinta da Pacheca, one of the finest estates along the Douro River. Return to the ship in Régua after the excursion. This evening, enjoy local entertainment onboard. **Meals: B, L, D**

**EmeraldACTIVE:** Walk down the stairs of the Sanctuary

**DiscoverMORE:** Visit to Mateus Manor House (additional expense)

This tour operates at the same time as the included visit of Lamego. Only one can be selected.

**EmeraldPLUS:** Rural lunch at Quinta da Pacheca

**EmeraldPLUS:** Mosaic tile painting lesson onboard

**DAY 10 Porto:** Having traversed the Douro River, the ship returns to Porto – a city with an eclectic mix of modern and ancient architecture. An included tour highlights the sights from its scenic beauty to the historic landmarks of the Castelo da Foz and Castelo do Queijo. For those who wish to see the charms of Porto on foot, the Active walk through the town will bring you closer to the vibrant daily life of the locals. The remainder of the afternoon is at leisure in Porto. **Meals: B, L, D**

**EmeraldACTIVE:** A guided walk of Porto (instead of included tour)

**DiscoverMORE\*:** Guided bike tour to the Atlantic Ocean (additional expense)

**DiscoverMORE\*:** Visit to Quinta do Aveleda (additional expense)

**EmeraldPLUS:** Cruise through Porto's enchanting waters

\* the DiscoverMORE's operate at the same time; only one can be selected.

**DAY 11 Porto / USA:** This morning, disembark the *MS Emerald Radiance* and bid a fond farewell to Portugal, filled with memories of this remarkable cruise along the 'River of Gold.' **Meal: B**

Itinerary and excursions are subject to change.



## Exceptional Inclusions

- **22 Meals:** 9 breakfasts, 5 lunches and 8 dinners
- **Airport transfers** on tour dates when air is provided by Mayflower Cruises & Tours
- **Visit two countries**
- Two-night **hotel stay and touring** in Lisbon, Portugal before cruising
- **Seven-night cruise** on the *Emerald Radiance*
- **First-class service** by an English-speaking crew
- **Onboard Activity Manager** will support all EmeraldACTIVE excursions and host daily onboard wellness activities, games, classes and evening entertainment
- **Shore excursions** with English-speaking **local guides**
- All **gratuities included**
- Personal **listening device** for onboard excursions
- Many meals included onboard with a **variety of international cuisine**
- Complimentary **regional wines, beer and soft drinks** accompany onboard lunches and dinners
- Complimentary **bottled water** in your stateroom
- Complimentary **WiFi onboard**
- Variety of **onboard evening entertainment**

## CRUISE AND HOTEL ACCOMMODATIONS

**Days 2 and 3** – Avani Hotel or similar, Lisbon, Portugal

**Days 4 through 10** – Aboard the *MS Emerald Radiance*

# MS Emerald Radiance

**Built:** 2017 **Speed:** 15.5 mph **Staterooms:** 10 **Suites:** 46 **Length:** 292 ft. **Crew:** 37

## SUN DECK

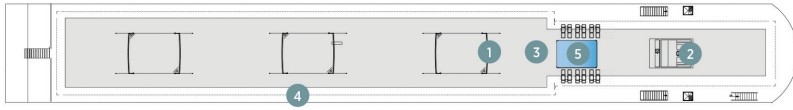

## HORIZON DECK

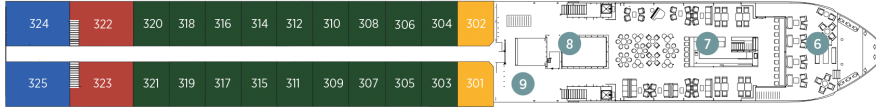

## VISTA DECK

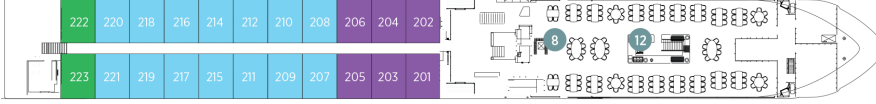

## RIVIERA DECK

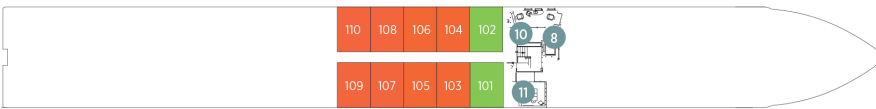

### Public Areas and Ship Amenities

- 1 Sun Deck with Deck Chairs
- 2 Navigation Bridge
- 3 Sky Barbeque
- 4 Walking Track
- 5 Serenity Pool
- 6 The Terrace
- 7 Horizon Bar & Lounge
- 8 Elevator
- 9 Reception
- 10 Wellness Area
- 11 Fitness Area
- 12 Reflections Restaurant

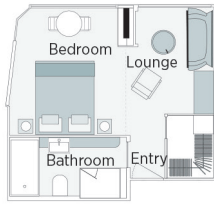

**Emerald Riverview Suite**

300ft<sup>2</sup>

CAT RA

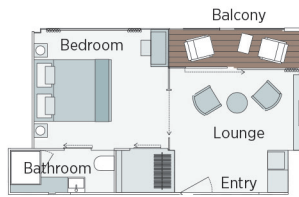

**Owner's One-Bedroom Suite**

285ft<sup>2</sup>

CAT SA



**Panorama Balcony Suite**

160ft<sup>2</sup> – 180ft<sup>2</sup>

CAT B CAT C CAT R CAT A CAT P

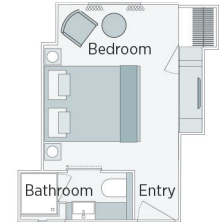

**Emerald Stateroom**

153ft<sup>2</sup> – 170ft<sup>2</sup>

CAT D CAT E

### Portugal and the Douro River Cruise

		APRIL 29, 2026	
CAT	STATEROOM / SUITE	DECK	
E	Emerald Stateroom	Riviera	PER PERSON TWIN: \$5,199; SINGLE ROOM ADD: + \$3,859
D	Emerald Stateroom	Riviera	PER PERSON TWIN: \$5,855; SINGLE ROOM ADD: + \$4,029
C	Panorama Balcony Suite	Vista	PER PERSON TWIN: \$6,215; SINGLE ROOM ADD: + \$4,285
B	Panorama Balcony Suite	Vista	PER PERSON TWIN: \$6,329; SINGLE ROOM ADD: + \$4,365
R	Panorama Balcony Suite	Vista	PER PERSON TWIN: \$6,689; SINGLE ROOM ADD: + \$4,615
A	Panorama Balcony Suite	Horizon	PER PERSON TWIN: \$7,115; SINGLE ROOM ADD: + \$4,915
P	Panorama Balcony Suite	Horizon	PER PERSON TWIN: \$7,295; SINGLE ROOM ADD: + \$5,039
SA	Owner's One-Bedroom Suite	Horizon	PER PERSON TWIN: \$7,839; SINGLE ROOM ADD: N/A
RA	Riverview Suite	Horizon	PER PERSON TWIN: \$7,965; SINGLE ROOM ADD: N/A

**Includes roundtrip FAR or BIS air, land/cruise package, hotel baggage handling, port charges, 22 meals, local wine and beer with lunches and dinners on ship, and gratuities to guides, drivers and ship staff!**



### Travelers Protection Plan (TPP) for River Cruises - \$569 per person OPTIONAL

This nonrefundable fee will provide a refund to you during the instance that you have to cancel your trip. The cancellation has to be for a covered reason (see Plan for details on coverage) and we have to be notified at least one day prior to departure. If you must leave the tour early due to personal illness or the illness or death of an immediate family member, TPP will provide a refund for any unused services after the departure of the tour. Other benefits include medical expenses for illness and injury, emergency transportation, 24 hour hot line and lost or stolen baggage assistance. Return air transportation is included ONLY if your air tickets are purchased through Mayflower Cruises & Tours. Please review the Plan for details on coverage. Should you choose not to purchase our TPP, the following per person cancellation charges will be assessed for all tours and optional excursion costs:

- 91 days or more prior to departure: Deposit Amount
- 90 days to day of departure: 100% of total tour
- No refund on unused portions of the tour

**Exclusions:** Mayflower Cruises & Tours reserves the right to alter its Refund and Cancellation Policy when a substantial amount of cancellation or postponement of travel is attributable to: conditions resulting from an act of God, natural or man-made disaster, fire, government action, civil disorder, war, hostilities between nations, or unavailability of transportation through no fault of Mayflower Cruises & Tours. *Plan and benefits offered and administered by Trip Mate, Inc.*



FOR RESERVATIONS OR INFORMATION CONTACT:

Judy or Sue  
**(701) 232-3441**

or

[judyltours@gmail.com](mailto:judyltours@gmail.com)

or

[sgoulet.jltours@gmail.com](mailto:sgoulet.jltours@gmail.com)



# 2026 RIVER CRUISING & SMALL SHIP ADVENTURES

## Booking Conditions

**Payments:** All deposits and final payments can be made by check or credit card. We accept the following credit cards: Visa, MasterCard and Discover.

**Prices Subject to Change:** We reserve the right to vary itineraries and prices and substitute facilities, hotels or events of equal or better quality if necessary.

**Guaranteed Share Program for Single Travelers:** If you are traveling alone and would like a roommate for cost savings, let us know at the time of booking your reservation. Travelers must be non-smokers, cannot use a medical sleeping device or have specific needs like Handicapped room etc. to be eligible. Participants will be paired with another traveler of the same gender at the twin rate. If no roommate is available, you will get a single room at the twin rate. Guaranteed share reservations are available 180 days prior to tour departure. Guaranteed share reservations are only available on certain Cabin categories. Please call us for details.

**Roommate Cancellation:** If you are booked as a "twin" and your roommate cancels their reservation, and you cannot find another roommate, you may either travel as a guaranteed share (see above) or travel as a single and pay the single supplement.

**Health and Walking on Tour:** Some sites visited have limited motorcoach access and may involve considerable walking, stairs or inclines. Travelers should be in reasonably good health. Some programs include destinations in higher elevations that may have varying effects on individual travelers. Tour Managers and Coach Drivers cannot lift or assist travelers into transportation vehicles. Mayflower Cruises & Tours requires that persons requiring assistance be accompanied by a companion who is capable of and totally responsible for providing the assistance.

**Revision Fees:** A fee of \$25 per person per transaction will be charged for any changes, revisions or alterations made to your reservation after confirmation.

**Luggage Handling:** The tour cost includes portage for one average size suitcase. A charge of \$5.00 per hotel will be collected by the Tour Manager for each additional piece of luggage that you bring.

**Travel Documents:** Your travel documents will be in your possession approximately 14 days prior to departure. Documents include tour itinerary, departure and arrival information and times, hotel and ship information, clothing suggestions, baggage tags, plus any helpful hints.

**Mayflower Loyalty Program:** Earn \$150.00 travel credit for every River Cruise and Small Ship Adventure taken with Mayflower Cruises & Tours. No restrictions to the amount of credits an individual can acquire. Loyalty Credits can be applied to any reservation made within one year of the return of the tour they were earned on. Multiple credits can be used on a single tour. Credits are nontransferable but can be combined with Mayflower promotional savings. Some restrictions apply, call for details.

**Smoke Free Environment:** All river cruise vessels have a no-smoking policy inside the vessel. There may be designated smoking areas outside on certain decks, and any smoking must be done in the designated areas only. While on the excursions, there is no smoking allowed on the motorcoach.

**Travelers with Special Needs:** You must advise Mayflower at the time your booking is made of any disability requiring special attention. Mayflower will make reasonable efforts to accommodate the special needs of our travelers. Be aware that the Americans with Disabilities Act is applicable only within the United States and that accommodations for disabled travelers outside the United States may be more limited. If a traveler requires assistance, we require that he/she be accompanied by a companion who is capable of and totally responsible for providing the assistance. Neither Mayflower personnel, nor its suppliers, may lift or physically assist travelers. If a traveler thinks he/she might need assistance during a trip, he/she should call Mayflower to determine what assistance might reasonably be provided. If special arrangements are provided, and these arrangements add to the Tour Operator's cost, the Tour Member will be responsible to pay the additional costs. Mayflower cannot provide special individual assistance to travelers with special needs for walking, dining or other routine activities. Travelers requesting a handicapped room cannot be booked with Guaranteed Share accommodations.

**Membership:** Mayflower reserves the right to withhold tour membership, or to require any traveler to leave a tour at any time, when such action is determined by Mayflower to be in the best interests of the traveler or the tour group. Children must be at least 12 years of age and accompanied at all times by a guardian.

**Force Majeure:** Except where otherwise expressly stated in these terms and conditions we cannot accept liability or pay any compensation where the performance or prompt performance of our obligations under our contract with you is prevented or affected by or you otherwise suffer any damage, loss or expense of any nature as a result of Force Majeure. "Force Majeure" means any event which we or the supplier of the services in question could not, even with all due care, foresee or avoid.

**Responsibility:** These tour programs are operated by Mayflower Cruises & Tours, Inc. 650 Warrenville Rd, Suite 500, Lisle, IL 60532. In common with other companies, Mayflower acts only as an agent for Tour Members in arranging room accommodations, transportation, sightseeing, admissions and restaurants. Mayflower reserves the right in its sole discretion to make changes in the itinerary and is not responsible for expenses, loss of time, money or other occurrence resulting from a change of tour scheduling made for Tour Members. Mayflower reserves the right to accept, decline or retain any person as a member of the tour, and is not responsible for any losses or damages of personal property, or for injuries, expenses or damages incurred by any Tour Member.

### United States Tour Operators Association \$1 Million Travelers Assistance Program

Mayflower Cruises & Tours, Inc. shares the coverage available under the United States Tour Operators Association ("USTOA") \$1 Million Travelers Assistance Program with affiliates of Mayflower Cruises & Tours who, as an Active Member of the USTOA is required to post \$1 Million with USTOA to be used to reimburse, in accordance with the terms and conditions of the USTOA Travelers Assistance Program, the advance payments of Mayflower Cruises & Tours travelers in the unlikely event of Mayflower Cruises & Tours bankruptcy, insolvency or cessation of business. Further, you should understand that the \$1 Million posted by Mayflower Cruises & Tours may be sufficient to provide only a partial recovery of the advance payments received by Mayflower Cruises & Tours. Complete details of the USTOA Travelers Assistance Program and a list of affiliates may be obtained by writing to USTOA at 345 Seventh Avenue, Suite 1801, New York, NY 10001, or by email to [information@ustoa.com](mailto:information@ustoa.com) or by visiting [www.ustoa.com](http://www.ustoa.com).

**Airline Security Measures:** The Transportation Security Administration requires that travelers provide their name exactly to their airline as it appears on their passport to be used while traveling, along with their date of birth and gender when making reservations to fly from the U.S. When making your flight reservations through Mayflower Cruises & Tours, you will be asked for this information by our staff. Due to airline security measures, your passport must match your airline ticket name and your tour reservation name or you may be denied aircraft boarding.

**Passport & Visas:** Each U.S. citizen must have a valid passport. Expiration date of passport should be at least six months after the return date of the tour. If you don't have a passport, call our office and we'll tell you how to apply for one. Some countries require visas for entry by U.S. citizens. We will send instructions for visa applications if a visa is required for your tour. Holders of non-U.S. passports should contact their nearest consulate and inquire about the necessary passport or visa documentation required for entry into the countries visited. Visa fees and cost of obtaining a visa are not included in the tour price and are the responsibility of the traveler.

**Medical Requirements:** Many countries have immunization requirements. Some countries require foreign visitors to have valid medical insurance on entry. Requirements vary by country and can change. Please check with your travel professional or call our office for details on which tours need these requirements. Specific instructions will be sent to you at 90 days prior to departure if your tour requires these conditions. Mayflower Cruises & Tours cannot be liable for delay or denial of entry due to missing documents.

**Itinerary Changes:** There may be times when we may have to alter the scheduled itinerary, cruise vessels, hotels, shore excursions etc. due to weather conditions or conditions on the river in regards to water levels, locks, or other delays. Any changes in the itinerary due to these

conditions will not result in eligibility for a refund. All itineraries are subject to change without prior notice and may need to be altered due to water level and other weather conditions.

**Cruise:** (a) Noise, Vibration and Odor: While We take reasonable steps to minimize noise, vibrations and odors on the cruise ships, You acknowledge and accept that some noise, vibration and intermittent odors may be experienced on vessels and that We will not be liable to You in relation to any such noise, vibration or odors.

(b) Docking Position: During port stops, ships may dock side-by-side, obstructing views and requiring You to pass through other ships to embark and disembark.

### THE TRAVEL PROTECTION OFFERED FOR RIVER CRUISES THE F431G PLAN.

#### DEPOSIT SCHEDULE - SCENIC, EMERALD AND GALÁPAGOS LAND/ CRUISE TOUR PRICE UP TO \$5,000

Land/Cruise Tour with Air*	Deposit Per Person	Final Payment
• With TPP Coverage	\$899	90 Days
• Without TPP Coverage	\$400	90 Days
Land/Cruise Tour Only	Deposit Per Person	Final Payment
• With TPP Coverage	\$899	90 Days
• Without TPP Coverage	\$400	90 Days

#### DEPOSIT SCHEDULE - SCENIC, EMERALD AND GALÁPAGOS LAND/ CRUISE TOUR PRICE FROM \$5,001 AND UP

Land/Cruise Tour with Air*	Deposit Per Person	Final Payment
• With TPP Coverage	\$969	90 Days
• Without TPP Coverage	\$400	90 Days
Land/Cruise Tour Only	Deposit Per Person	Final Payment
• With TPP Coverage	\$969	90 Days
• Without TPP Coverage	\$400	90 Days

#### DEPOSIT SCHEDULE - TREASURES OF THE PHAROAH'S

Land/Cruise Tour with Air*	Deposit Per Person	Final Payment
• With TPP Coverage	\$899	90 Days
• Without TPP Coverage	\$400	90 Days
Land/Cruise Tour Only	Deposit Per Person	Final Payment
• With TPP Coverage	\$899	90 Days
• Without TPP Coverage	\$400	90 Days

#### DEPOSIT SCHEDULE - MAJESTIC MEKONG RIVER CRUISE; TREASURES & TEMPLES OF VIETNAM AND CAMBODIA; SPLENDORS OF EUROPE

Land/Cruise Tour with Air*	Deposit Per Person	Final Payment
• With TPP Coverage	\$969	90 Days
• Without TPP Coverage	\$400	90 Days
Land/Cruise Tour Only	Deposit Per Person	Final Payment
• With TPP Coverage	\$969	90 Days
• Without TPP Coverage	\$400	90 Days

\*Land tour price is based on twin occupancy rate

**Payment Information:** Listed above is a schedule of deposit and final payment due dates. You will note that the first category includes an optional Travelers Protection Plan (TPP). Within five business days of making your reservation, you must make your initial trip deposit. Once your trip deposit is made, you then have 24 hours to add on the Optional TPP if you choose to purchase. Please see "Travelers Protection Plan (TPP)" section in the next column for further explanation of this offering.

**Refund and Cancellation Policy:** Payments for land, air, cruise arrangements, (less the deposit amount) will be refunded when cancellations are received prior to the final payment due date noted above. Deposits are non-refundable unless the optional Travel Protection Plan (TPP) is purchased at the time of booking and you have a covered claim. The Refund and Cancellation Policy is offered by Mayflower Cruises and Tours and is separate from the Travel Protection Plan.

These plans are not available to purchase for residents of New York. If you are a resident of New York and interested in purchasing a Travel Protection plan, please contact us@1-800-323-7607.

New York residents please review further details [www.tripmate.com/wpr774](http://www.tripmate.com/wpr774)